

# SUBMITTAL DATA

HYDRO MAXX

**MODEL NO** PTAC: MWDUP-12AEN1-MJ5 (24V North American Universal Controller) 42" PACKAGED  
TERMINAL A/C & H/P 12000Btu & 3500W

**JOB NAME:** ..... **LOCATION:** ..... **DATE:** .....  
**PURCHASER:** ..... **ENGINEER:** .....  
**SUBMITTED TO:** ..... **FOR:** ..... **REVIEW ( )** **APPROVAL ( )**



## Features:

- Compressor 3 minutes delay protection
- Auto-start function
- Automatic evaporator freeze protection
- Automatic quick warm-up
- LED indicators and control buttons
- High temperature protection in heating operation
- Unit configuration - the unit can display in either °C or °F
- Self-diagnostics - our PTAC's have a self-check error function, error code will be shown on electric display panel
- Ideal for commercial use in hospitals, hotels, and more

## Warranties:

- 1 - year limited warranty on entire unit
- 5 - year limited warranty on sealed system

### PERFORMANCE DATA

Power supply	Ph-V-Hz	230/208V-,60Hz
--------------	---------	----------------

#### Cooling

Capacity	Btu/h	12000/11800
Input	W	1142/1124
Current	A	4.97/5.4
EER	Btu/w	10.5

#### Heating(Heat pump)

Capacity	Btu/h	10800/10500
Input	W	990/963
Current	A	4.3/4.63
COP	W/W	3.20

#### Heating(PTC)

		<b>PTC 1</b>
Capacity	Btu/h	10900/8900
Input	W	3519/2850
Current	A	15.3/13.7
MINIMUM CIRCUIT AMPACITY	A	20

#### Compressor Electrical

Model		PA108M1C-3FZDU
Type		ROTARY
Brand		GMCC
Capacity	Btu/h	10714/10850
Input	W	1045/1050
Rated current(RLA)	A	5.0/4.55
Locked rotor Amp(LRA)	A	25.9
Thermal protector		B185-135-141C
Thermal protector position		EXTERNAL
Capacitor	uF	35
Refrigerant oil/oil charge	ml	ESTEL OIL VG74.350ml
Connection wiring		12AWGx3
Plug type		LCDI 6-20P
Thermostat type		Electronic Control

#### SYSTEM DATA

Design pressure	PSIG	540/300
Refrigerant type	oz	R410A/31.39ozs
Application area (Cooling EPA)	sq.ft	450-500
Application area (Cooling Stand)	m <sup>2</sup>	16-23

### UNIT DIMENSION

Dimension(W*D*H) (without	inch	42x21x16
Packing (W*D*H)	inch	45x25.4x19.3
Net/Gross weight	Kg	53.5/65
	lbs.	117.9/143.3
Loading quantity 20' /40' /40'	Pieces	72/144/180

### INDOOR SIDE DATA

Indoor side fan motor		
Model		YDK20-6BS
Brand		Welling
Input		35.5
FLA / OUTPUT	A / Wat	0.155 / 21
Capacitor	uF	1.0
Speed(Hi/Mi/Lo)	r/min	1110/1070/1040
<b>Air flow &amp; Noise level</b>		
Indoor side air flow (Hi/Mi/Lo)	m3/h	740/720/700
Indoor side air flow (Hi/Mi/Lo)	CFM	435/423/411
Indoor side noise level (Hi/Mi/Lo)	dB(A)	53/50/45

### OUTDOOR SIDE DATA

Outdoor side fan motor		
Model		YDK40-4B
Brand		Welling
Input		87
FLA / OUTPUT	A / Wat	0.41 / 58
Capacitor	uF	3.0
Speed	r/min	1590
<b>Air flow &amp; Noise level</b>		
Outdoor side noise level	dB(A)	66

### Operation temperature

Indoor (cooling/ heating)	°C	17-32/0-27
	°F	62°F-90°F/32°F-80°F
Outdoor(cooling/heating)	°C	18-43/-5-24
	°F	64°F-109°F/23°F-76°F

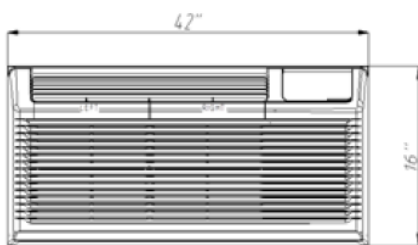

Front View

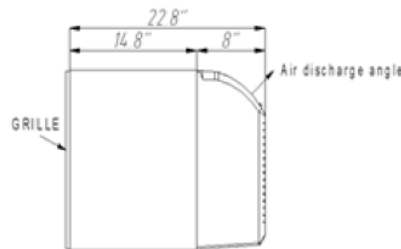

Side View

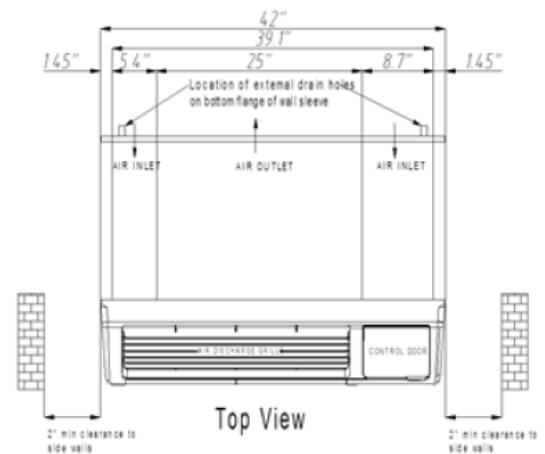

Top View

2028217A0010	UNIVERSAL WALL SLEEVE & CONDENSATE DRAIN KIT
2028217A0030	KNOWN DOWN UNIVERSAL WALL SLEEVE
2028217A0011	STANDARD OUTDOOR GRILLE
2028217A0012	ARCHITECTURAL OUTDOOR GRILLE
2033551A4195	DIGITAL WIRED WALL THERMOSTAT



**Condensate  
Drain Kit  
(included with  
wall sleeve)**



**Wall Sleeve**

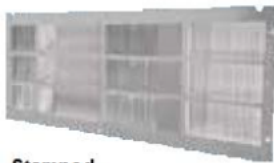
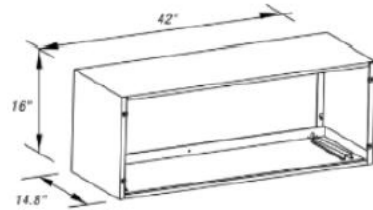

**Stamped  
Aluminum Grille**



**Extruded  
Architectural  
Grille**



**Wired  
Thermostat**

