

SUBMITTAL DATA

HYDRO MAXX

MODEL NO PTAC: MWDUP-09AEN1-MK3 (24V North American Universal Controller) 42" PACKAGED
TERMINAL A/C & H/P 9000Btu & 3500W

JOB NAME:..... **LOCATION:** **DATE:**
PURCHASER: **ENGINEER:**
SUBMITTED TO: **FOR:** **REVIEW ()** **APPROVAL ()**



Features:

- Compressor 3 minutes delay protection
- Auto-start function
- Automatic evaporator freeze protection
- Automatic quick warm-up
- LED indicators and control buttons
- High temperature protection in heating operation
- Unit configuration - the unit can display in either °C or °F
- Self-diagnostics - our PTAC's have a self-check error function, error code will be shown on electric display panel
- Ideal for commercial use in hospitals, hotels, and more

Warranties:

- 1 - year limited warranty on entire unit
- 5 - year limited warranty on sealed system

PERFORMANCE DATA

Power supply	Ph-V-Hz	230/208V-,60Hz
--------------	---------	----------------

Cooling

Capacity	Btu/h	9000/8800
Input	W	796/778
Current	A	3.46/3.75
EER	Btu/w	11.3

Heating(Heat pump)

Capacity	Btu/h	8100/7900
Input	W	716/699
Current	A	3.04/3.28
COP	W/W	3.40

Heating(PTC)

		PTC 1
Capacity	Btu/h	10900/8900
Input	W	3519/2850
Current	A	15.3/13.7
MINIMUM CIRCUIT AMPACITY	A	20

Compressor Electrical

Model		PA78G0C-3DZD
Type		ROTARY
Brand		GMCC
Capacity	Btu/h	7745/7847.6
Input	W	770/785
Rated current(RLA)	A	3.75/3.5
Locked rotor Amp(LRA)	A	18
Thermal protector		B120-135-141C
Thermal protector position		EXTERNAL
Capacitor	uF	25
Refrigerant oil/oil charge	ml	ESTER OIL VG74.250ML
Connection wiring		12AWGx3
Plug type		LCD16-20P
Thermostat type		Electronic Control

SYSTEM DATA

Design pressure	PSIG	540/300
Refrigerant type	oz	R410A/24.69ozs
Application area (Cooling EPA)	sq.ft	350-400
Application area (Cooling Stand)	m ²	12-18

UNIT DIMENSION

Dimension(W*D*H) (without	inch	42x21x16
Packing (W*D*H)	inch	45x25.4x19.3
Net/Gross weight	Kg	48.5/60
	lbs.	106.9/132.3
Loading quantity 20' /40' /40'	Pieces	72/144/180

INDOOR SIDE DATA

Indoor side fan motor		
Model		YDK20-6BS
Brand		Welling
Input		35.5
FLA / OUTPUT	A / Wat	0.155 / 21
Capacitor	uF	1.0
Speed(Hi/Mi/Lo)	r/min	1110/1070/1040
Air flow & Noise level		
Indoor side air flow _w (Hi/Mi/Lo)	m ³ /h	740/710/670
Indoor side air flow _w (Hi/Mi/Lo)	CFM	435/417/394
Indoor side noise level (Hi/Mi/Lo)	dB(A)	50/48/46

OUTDOOR SIDE DATA

Outdoor side fan motor		
Model		YDK30-4B
Brand		Welling
Input		69
FLA / OUTPUT	A / Wat	0.35 / 37
Capacitor	uF	3.0
Speed	r/min	1400
Air flow & Noise level		
Outdoor side noise level	dB(A)	61

Operation temperature

Indoor (cooling/ heating)	°C	17-32/0-27
	°F	62°F-90°F/32°F-80°F
Outdoor(cooling/heating)	°C	18-43/-5-24
	°F	64°F-109°F/23°F-76°F

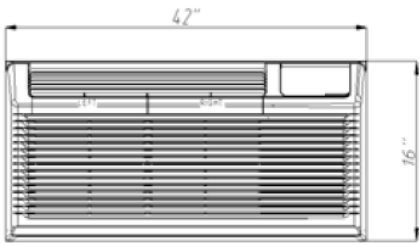

Front View

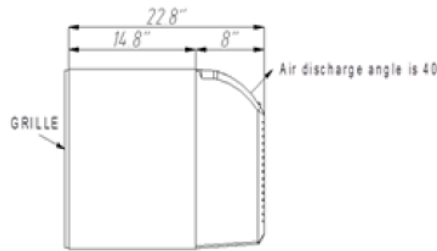

Side View

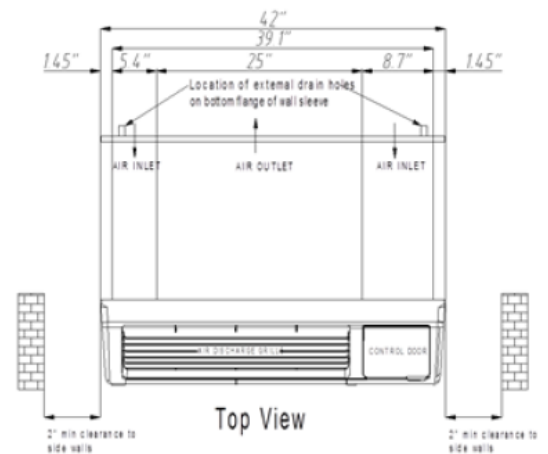

Top View

2028217A0010	UNIVERSAL WALL SLEEVE & CONDENSATE DRAIN KIT
2028217A0030	KNOWN DOWN UNIVERSAL WALL SLEEVE
2028217A0011	STANDARD OUTDOOR GRILLE
2028217A0012	ARCHITECTURAL OUTDOOR GRILLE
2033551A4195	DIGITAL WIRED WALL THERMOSTAT



**Condensate
Drain Kit
(included with
wall sleeve)**



Wall Sleeve

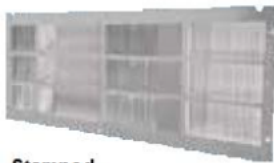
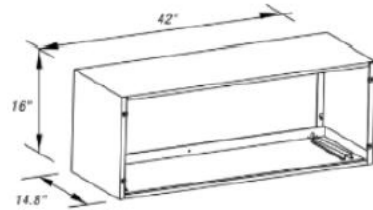

**Stamped
Aluminum Grille**



**Extruded
Architectural
Grille**



**Wired
Thermostat**

